

MESH DESIGN PRINCIPLES



Rule of Thumb



Never put a mesh controller in a rack. Racks block wireless signals.



2nd Finger

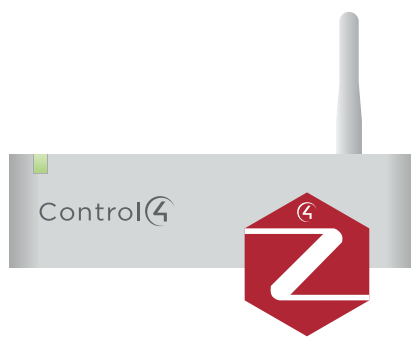

Use secondary controllers for mesh controllers.



Middle Finger

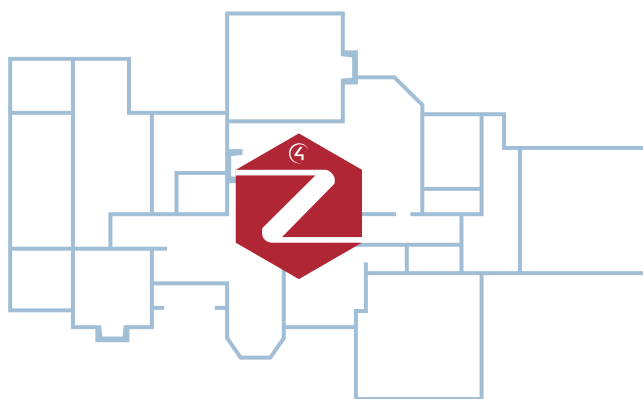

Put the mesh controller central to the devices in each mesh.



Ring Finger



Never locate WiFi access points within a 5 meter (15 feet) ring around a mesh controller.



Small Finger



Limit a mesh to fewer than 70 devices. For more than 70, setup additional mesh controllers.

MESH DESIGN PRINCIPLES



Never use WiFi on a mesh controller.

WiFi Channels

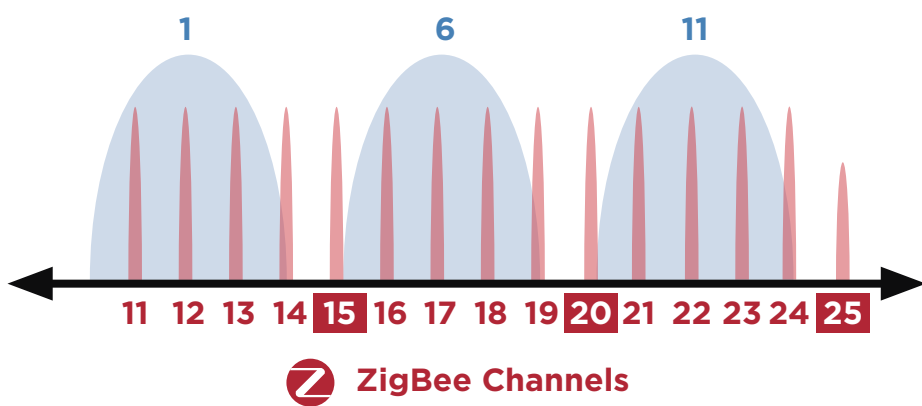

Select a ZigBee channel that does not overlap with WiFi. ZigBee channels 15, 20, and 25 work best with the most common WiFi channels.

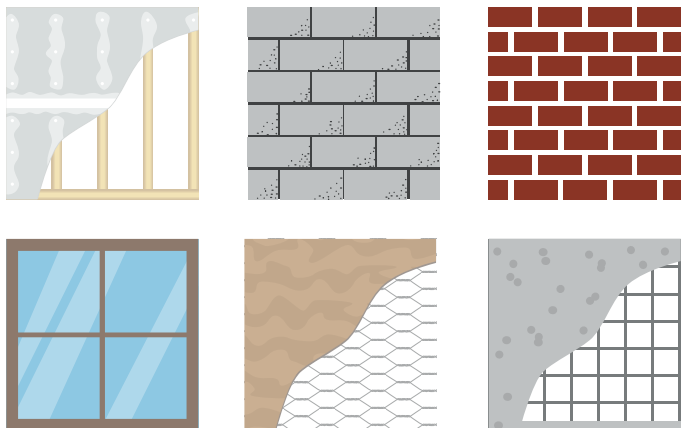

Construction materials significantly attenuate or block ZigBee signals.



Don't put a mesh controller near an interference source.

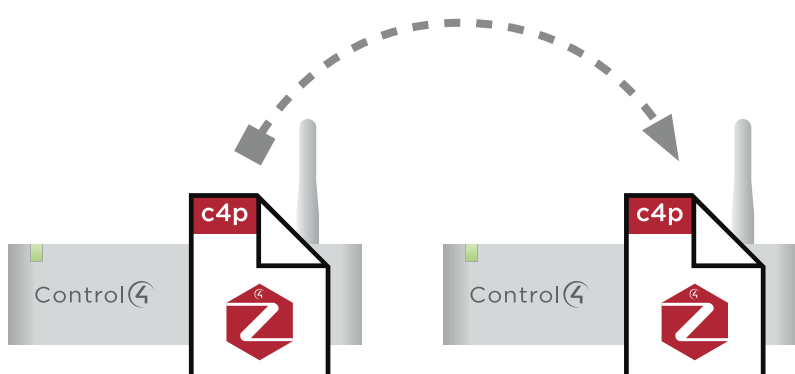

Never copy a project that has an existing mesh controller to another nearby controller.