

Lighting Extrusion Installation Guide

Supported models

- C4-LEEL5-F-3F – Fixed Color Extrusion, 3.25 ft (1 m)
- C4-LEEL5-SQ-U-3F – Universal Square 45-Degree Extrusion, 3.25 ft (1 m)
- C4-LEEL5-45-U-3F – Universal 45-Degree Extrusion, 3.25 ft (1 m)
- C4-LEEL5-UE-3F – Universal Economy Extrusion, 3.25 ft (1 m)
- C4-LEEL5-U-3F – Universal Extrusion, 3.25 ft (1 m)
- C4-LEHS5-U-3F – Universal Heat Sink, 3.25 ft (1 m)
- C4-LEE5-UO-3F – Universal Outdoor Extrusion, 3.25 ft (1 m)
- C4-LEEL3-IW-F-6F – Fixed Color In-Wall Extrusion, 6.58 ft (2 m)
- C4-LEEL3-IW-U-6F – Universal In-Wall Extrusion, 6.58 ft (2 m)

Introduction

Control4 Vibrant Light Extrusions provide protection and dissipate heat for Control4 Vibrant Linear Lights. Most models are supplied with lenses that diffuse the light to help create consistent lighting.

Box contents

- Extrusions (5)
- Lenses (5) (Not applicable to C4-LEHS5-U-3F & C4-LEE5-UO-3F)
- Power Feed End Cap (5)
- End Cap (5)
- Mounting Clip (25) (Only for C4-LEEL5-SQ-U-3F)

Specifications

Model	Outer Dimensions (WxH)	Length
C4-LEEL5-F-3F	5/8 x 1/2" (16 x 12 mm)	3.25 ft (1 m)
C4-LEEL5-SQ-U-3F	25/32 x 29/32" (20 x 23 mm)	3.25 ft (1 m)
C4-LEEL5-45-U-3F	1-3/16 x 7/16" (30 x 10 mm)	3.25 ft (1 m)
C4-LEEL5-UE-3F	5/8 x 1/4" (16 x 7 mm)	3.25 ft (1 m)
C4-LEEL5-U-3F	13/16 x 13/16" (21 x 21 mm)	3.25 ft (1 m)
C4-LEHS5-U-3F	1/2 x 1/16" (12 x 2 mm)	3.25 ft (1 m)
C4-LEE5-UO-3F	13/16 x 11/16" (21 x 18 mm)	3.25 ft (1 m)
C4-LEEL3-IW-F-6F	1-5/8 x 15/16" (67 x 24 mm)	6.58 ft (2 m)
C4-LEEL3-IW-U-6F	4-27/32 x 7/8" (124 x 22 mm)	6.58 ft (2 m)

Warnings and considerations

IMPORTANT! Control4 does not guarantee the performance of any bulb or lamp/fixture in your environment. Customer assumes all risks, including any damage to control4 products, associated with (i) the type, load rating and quaility of the bulb and lamp/fixture, or (ii) any use or installation not in accordance with the documentation furnished by control4, either with the control4 product or at www.control4.com.

Cutting extrusions and lenses

When measuring to cut an extrusion, include as many of the six countersunk mounting holes (if present) as possible and ensure the outermost holes are equidistant to the ends. If using power feed connectors, allot space for them in the extrusion. If using end caps, trim the lens slightly shorter than the extrusion. Using a miter box and hack saw, cut the extrusion and the lens to the desired length.

Mounting extrusions

Extrusions are mounted differently depending on the model. Standard extrusions (C4-LEEL5-F-3F, C4-LEEL5-UE-3F, C4-LEEL5-U-3F, C4-LEHS5-U-3F, C4-LEE5-UO-3F), are mounted using countersunk holes in the channel. The square 45-degree extrusion (C4-LEEL5-SQ-U-3F) is mounted using clips. The in-wall extrusions (C4-LEEL3-IW-F-6F, C4-LEEL3-IW-U-6F), are mounted using the perforations on both sides of the channel. Mounting procedures are listed below.

Standard extrusions

Mount the extrusion using screws (not included) appropriately-sized for the application.

Square 45-degree extrusion

- Mark a straight line on the surface where you want to mount the extrusion.
- Center a mounting clip on the marked line. Using a #4 screw, mount the clip. Repeat this for the remaining clips, spacing them evenly.
- Snap the extrusion onto the clips.

In-wall extrusions

- Mill out a channel in the drywall.
 - For the universal in-wall model (C4-LEEL3-IW-U-6F), make the channel 1.8" (46 mm) wide and 0.5" (13 mm) deep.
 - For the fixed color in-wall model (C4-LEEL3-IW-F-6F), make the channel 1.0625" (27 mm) wide and 1" (25.4 mm) deep (you may need to cut a notch into the studs for this model).
- Install the lens into the extrusion to prevent warping later when fastening it to the wall. Apply masking tape over the lens.
- If using C4-LEEL3-IW-U-6F, pre-drill holes in the flanges on both sides of the channel. Otherwise, skip this step.
- Place the extrusion into the wall and fasten it with screws through the holes in the flanges.
- Place mudding mesh over the holes in the flanges.
- Mud over the mesh and blend into the surface.
- Sand the mud when it is dry for a smooth finish.
- Remove the masking tape and the lens from the extrusion.

Installing tape lights

Clean the extrusion to remove any debris. Then, adhere the tape light into the aluminum channel. Refer to the cross-section diagrams on the next page. The red lines indicate where you may apply tape light. If needed, refer to the tape light's documentation for installation instructions.

Installing lenses

Depending on the extrusion model, lenses may be clipped in or slid in from one end.

- Universal: clip or slide
- Universal in-wall: clip or slide
- Fixed color in-wall: clip or slide
- Universal Economy: clip only
- Square 45: clip only
- Fixed color: clip or slide
- 45 degree: clip or slide

Slide-in

If one end of the extrusion is exposed after installation, slide the lens into that end of the extrusion. However, if both ends of the extrusion are blocked, use the following clip-in method.

Clip-in

For the Universal Extrusion (C4-LEEL5-U-3F), clip the lens over the outside of the extrusion. For the other models, place one side of the lens into the extrusion (1). Then, press one corner into the extrusion (2) and bend the lens (3) into place (4). Once you have it started, work your way down the length of the extrusion until the entire lens is seated properly.

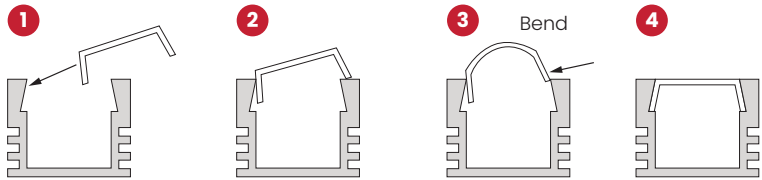

This diagram shows a typical application only, but the same principle may be applied to other extrusion models.

- TIP:** To ease clip-in lens installation, leave the lens out in the sun to warm up for about an hour before installation.
- NOTE:** Universal Heat Sink and Universal Outdoor extrusions do not support lenses.

Installing end caps and power feed end caps

Press an end cap into the end of the extrusion, if needed. Trim the lens to allow space for the end cap. For power feed end caps, run the power wires through the hole, then press into the end of the extrusion.

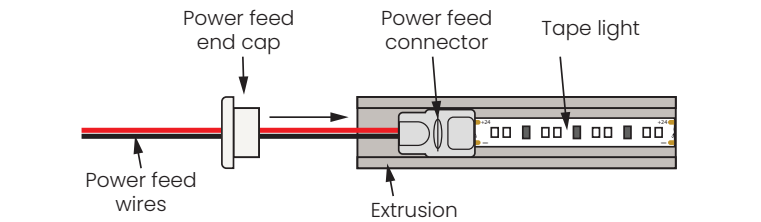

NOTE: Power feed connectors do not fit inside all extrusion models. In those cases, the power feed connectors may be left outside the extrusion or the power feed wires may be soldered directly into the tape light. Refer to the Extrusion Compatibility table (below) for specifics on your extrusion model.

Extrusion Compatibility

The following table shows which tape light connectors fit inside the different extrusion models.

	Connectors				
Extrusion Name	Block	2-Wire	4-Wire	5-Wire	6-Wire
Fixed Color	•				
Universal Economy					
Universal	•	•	•		
Univ. Square 45-Deg.	•	•	•	•	•
Universal 45-Degree					
Fixed Color In-Wall	•	•	•	•	•
Universal In-Wall	•	•	•	•	•
Universal Heat Sink	n/a	n/a	n/a	n/a	n/a
Universal Outdoor	n/a	n/a	n/a	n/a	n/a

Extrusion Dimensions and Cross-Sections

Dimension and cross-section diagrams for all extrusions are shown on the next page.

Warranty and legal information

Find details of the product's Limited Warranty at snapone.com/legal or request a paper copy from Customer Service at **866.424.4489**.

Find other legal resources, such as regulatory notices and patent information, at snapone.com/legal.

