

WA-2200 WAVE 2 ACCESS POINT SOLUTIONS GUIDE



WA-2200 WAVE 2 ACCESS POINT

NEXT GENERATION WIRELESS

The WA-2200 Wave 2 Access Point is designed to meet the growing performance demands of today's smart home. The WA-2200 leverages next generation wireless technology to deliver exceptional performance and reliable connectivity to smart devices throughout the home. Wave 2 and beamforming technologies ensure high-throughput connectivity for bandwidth-intensive devices and real-time applications. The all-new, high-performance chipset delivers faster speeds, lowers latency, and ensures seamless roaming to every corner of the home. Get the wireless network running quickly with a streamlined setup and built-in remote management through BakPak. The WA-2200 is the smallest Pakedge access point available, with a sleek design to enable discrete installation.

Fast, reliable wireless performance for the smart home

- > All-new, high-performance chipset delivers fast speeds, reliability, and smooth client hand-offs anywhere in the home.
- > Beamforming technology automatically optimizes RF signals to devices demanding sustained throughput for bandwidth-intensive and real-time applications.
- > Wave 2, an advanced feature of 802.11ac, enhances performance and lowers latency by transmitting to multiple devices simultaneously.

Redesigned setup process makes configuration quick, easy, and error-free

- > Setup and configuration are streamlined with a single-page setup and intuitive navigation to save time and reduce configuration errors.
- > Secure-by-design new password requirements protect your customers and ensure the access point is never left with a "default" username and password.
- > BakPak is built-in, providing complete configuration, remote management, and monitoring from a desktop or mobile app.
- > Built-in RF scan, client monitoring, and analytics for fine-tuning and monitoring the network ensure peak performance for every device.

Streamlined multi-AP deployments with complete BakPak cloud configuration

- > Controller-less multi-AP deployment is now included with WA-2200 and BakPak, eliminating additional hardware costs and reducing deployment time.
- > Push configurations to connected APs with a single click from the BakPak web interface or mobile app.
- > Registering additional APs to BakPak is quick and easy with BakPak's auto-enroll and AP discovery features.

Small form factor; aesthetic design

- > Small and sleek design includes both on-ceiling and flush-mount in-ceiling mounting options.
- > Mounting template and accessory kit included for easy installation.

FAST, RELIABLE WIRELESS PERFORMANCE

The WA-2200 delivers exceptional wireless performance, fast speeds, and reliable connectivity to every device in today's smart home.

Next generation chipset

The WA-2200 features an all-new, high-speed chipset with a quad-core CPU that delivers accelerated processing power and faster speeds to client-dense smart homes. It also utilizes the latest wireless drivers, engineered to deliver an exceptional roaming experience with real-time VoIP and video streaming applications anywhere in the home.

Beamforming technology

Beamforming technology focuses the AP RF signal in the direction of devices demanding sustained throughput, eliminating latency and delivering optimal performance for high-speed devices and real-time applications such as VoIP, 4K/HD video, real-time gaming, and more. Beamforming also suppresses interfering signals, delivering smooth, reliable connections.

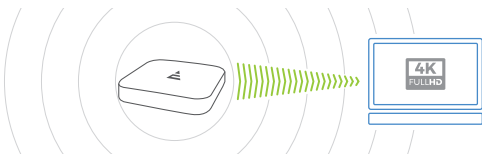

Wave 2 MU-MIMO technology

Next generation 802.11ac Wave 2 with MU-MIMO (Multi-User, Multi-Input, Multi-Output) technology enables multiple, simultaneous connections to connected devices, dramatically improving wireless network performance. MU-MIMO also improves network capacity and efficiency. Devices can get on and off the network faster, allowing it to handle many bandwidth-intensive applications simultaneously.

Single-User MIMO

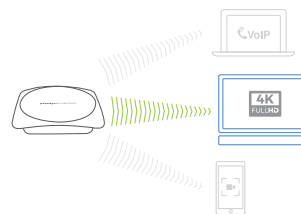

One device at a time

Multi-User MIMO

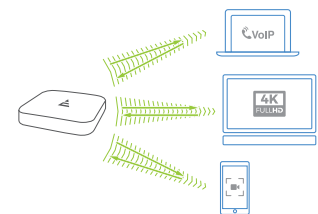

Multiple devices simultaneously

REDESIGNED SETUP PROCESS

The WA-2200 streamlines setup and configuration for single- and multi-AP deployments. Getting your AP set up is fast and easy with key setup features—including username and password, SSIDs, and guest networks—listed on a single page. Intuitively navigate to advanced settings on other tabs. Secure by design, the new password requirement ensures your customers are protected.

Initial setup

Quick-setup features are available on a single page for faster, streamlined deployment.

New password requirements

Change the default username and password for increased security.

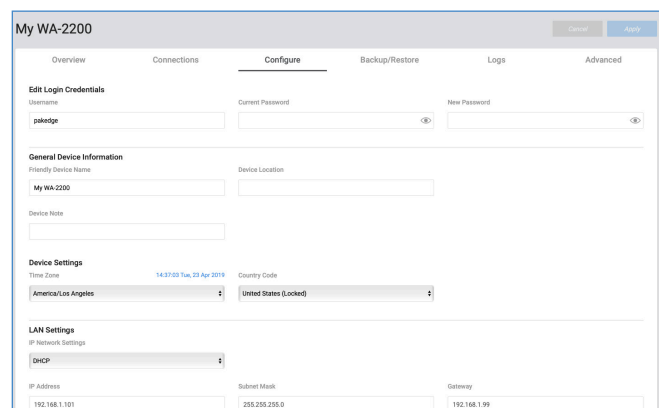

My WA-2200

Overview | Connections | **Configure** | Backup/Restore | Logs | Advanced

Edit Login Credentials

Username: Current Password: New Password:

General Device Information

Friendly Device Name: Device Location:

Device Note:

Device Settings

Time Zone: 14:37:03 Tue, 23 Apr 2019 Country Code:

LAN Settings

IP Network Settings:

IP Address: 192.168.1.101 Subnet Mask: 255.255.255.0 Gateway: 192.168.1.99

COMPLETE CLOUD CONFIGURATION WITH BAKPAK

With BakPak Lite built-in, the WA-2200 can be configured, managed, and monitored with BakPak. BakPak now supports the configuration of all wireless settings. From SSIDs and passwords profiles, channel and transmit power levels, and roaming technologies, WA-2200 enables complete configuration of the wireless network either remotely or onsite from the BakPak web interface and mobile app. With secure remote login, access the WA-2200 user interface directly from BakPak, eliminating the need for separate remote VPN access.

Enroll WA-2200 to BakPak

From the WA-2200, enroll to BakPak and assign to a new BakPak site to start configuring the AP remotely.

Complete cloud configuration

With BakPak Lite built in, all wireless WA-2200 settings are available in BakPak.

Secure remote login

Remote access to the WA-2200 user interface.

bakpak®

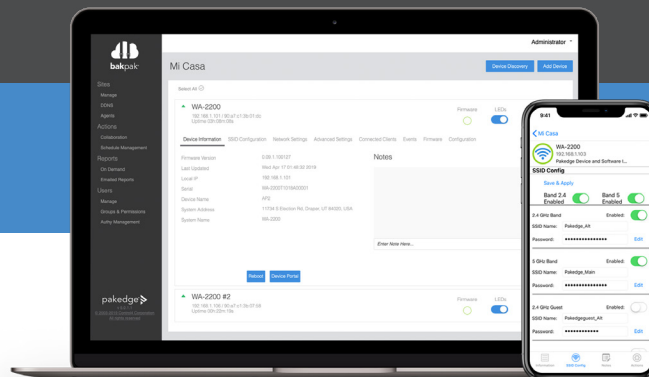

MULTI-AP DEPLOYMENTS WITH BAKPAK

Multi-AP deployments are now easier than ever with BakPak. Complete BakPak cloud configuration enables controller-less multi-AP deployments, eliminating additional hardware costs and reducing deployment time. Discover additional APs on the network, and with a single click, automatically enroll each AP to BakPak for faster setup. After discovery, push all configuration settings to connected APs, deploying your multi-AP wireless network in just minutes.

Step 1

Configure the first WA-2200 and enroll to BakPak.

Step 2

Connect additional APs to the network.

Step 3

Discover additional APs for automatic BakPak enrollment.

Step 4

Push configuration settings to connected APs to complete setup.

REMOTE MANAGEMENT & CONFIGURATION WITH BAKPAK



BakPak enables you to provide proactive service to all of your customers with centralized management with BakPak. With BakPak built in, it's easy to remotely configure, monitor, and manage your customers' wireless networks. Receive alerts, update firmware, or push wireless configuration settings – to a single AP or multi-AP systems – from your desktop or mobile app.



The BakPak iOS or Android mobile apps enable on-the-go network configuration and management. Receive alerts, update firmware, or push wireless configuration settings from anywhere in the world.

FINE-TUNING CAPABILITIES

The WA-2200 includes a host of tools to assist with fine-tuning the network, during and after deployment, to ensure peak performance for every device. With BakPak's secure remote login, access the local UI remotely for easy access to these tools.

AP services & analytics

Get a snap-shot of bandwidth utilization, memory/CPU usage, channel utilization on 5 GHz and 2.4 GHz, LAN/WAN connectivity, and more.

RF coverage service

Monitor the RSSI values of connected clients—along with suggested remedies—when a connected client falls below the recommended RF coverage.

Current Status	Up (for 4d 13h 01m 10s)
Subnet	255.255.255.0
Gateway	192.168.1.99
5 GHz	
Access Point	AUTO (40) HT80
1	0
SSIDs	Clients
1%	1%
SSIDs	Channel Utilization
2.4 GHz	
Access Point	AUTO (6) HT20
1	0
SSIDs	Clients
1%	31%
SSIDs	Channel Utilization
Services	
Service Name	Service Data
RF Coverage	No clients are connected
LAN 1 Bandwidth Utiliz...	Realtime: 0% (15.62 Kbps), 1 Minute Average: 0%, 5 Minute Average: 0%
LAN 1 Bandwidth Utiliz...	Realtime: 0% (18.07 Kbps), 1 Minute Average: 0%, 5 Minute Average: 0%
Serial Number	WA-2200
Memory Usage	Realtime: 63%, 1 Minute Average: 63%, 5 Minute Average: 63%
CPU Usage	Realtime: 32%, 1 Minute Average: 33%, 5 Minute Average: 33%
Sub-optimal radio conf...	
LAN Port Status	Ethernet Port: UP, Speed: 1Gbps, Mode: Full Duplex

Real-time monitoring of connected clients

Monitor the reliability and signal strength of connected clients on 5 GHz and 2.4 GHz bands.

Built-in RF scan

RF scan for 5 GHz and 2.4 GHz to help fine-tune the network when dealing with high-interference, client-dense environments.

RF Scan Result			
Current Channel 44 Transmit Power 18 dBm Bandwidth HT80			
5 GHz			
Channel	SSID Count	Utilization	Strongest RSSI
36	7	2%	-80dBm
40	0	1%	-95dBm
44	0	1%	-95dBm
48	3	1%	-45dBm
149	1	2%	-89dBm
153	2	3%	-60dBm
157	3	3%	-66dBm

INSTALLER-FRIENDLY WITH SLEEK, AESTHETIC DESIGN

The WA-2200 includes a mounting template and accessory kit for easy installation, with a small, sleek, and aesthetically-designed form factor that customers can be proud to put in their home.



Design features

Smallest Packedge AP to date!
New, sleek design to complement any home décor



Install with ease

Includes mounting template and accessory kit for easy installation



Powered by PoE

802.11af PoE eliminates the need to run extra wires. Connect the WA-2200 to a PoE switch and you're ready to go! Power supply sold separately.

MOUNTING OPTIONS



WA-2200 Surface Mount



WA-2200-C Flush Mount

SPEEDS & FEEDS

- > Dual-band 802.11ac
- > 2x2:2 Wave 2 MU-MIMO
- > 1300 Mbps max data rate
- > Beamforming technology
- > Auto channel selection
- > 802.11r/k/v roaming standards
- > 8 SSID (4 per band), 2 Guest SSIDs
- > WPA2-PSK security encryption
- > Cloud configuration with BakPak
- > 802.11af PoE-compliant
- > 12W PoE power draw (peak)
- > Internal antennas

PAKEDGE WIRELESS ADVANTAGE

- > Pakedge offers a strong portfolio of high-performance wireless products, including the new WA-2200 access point, with faster speeds, greater coverage, and uncompromised reliability at competitive price points.
- > With BakPak built in to all Pakedge access points, you can remotely manage, configure, and monitor all your customers' wireless networks from a central location.
- > You can be confident that Pakedge wireless solutions deliver exceptional, reliable performance and consistent coverage for every size home.

HOMEOWNER BENEFITS

- > Pakedge wireless delivers peace of mind with high-performance, reliable wireless networks.
- > Pakedge wireless supports the growing performance demands of your smart home.
- > Your network expert will professionally install and provide remote management support for your network—now and in the future.
- > Pakedge access points are designed to blend in with — not detract from — the aesthetics of your home.

SHOWCASE PAKEDGE

Install It in your showroom

The reliability and performance of a Pakedge network needs to be experienced and understood by customers. Install Pakedge networks in your showroom. For a top-notch selling experience, connect smart device solutions such as automation, video streaming, smart lighting, voice control, or security to the Pakedge network and demonstrate the lightning-fast speed that Pakedge networks offer.

Incorporate into your showroom demo

As you are demonstrating any category or solution in your showroom, incorporate the network into every conversation and demonstrate how the solution is dependent on the network for optimal performance.

Install it in your home

More confidently share the network story and Pakedge experience with customers by deploying a Pakedge network in your own home. Sharing your personal experience with Pakedge networks helps build more confidence with the customer.

NETWORK DESIGN SERVICES

We're here to help with your projects for every size of network. Network Design Services is available to dealers at no charge. Submit a residential floor plan, and we will provide you a network design with a budgetary bill of materials. Available through the Dealer Portal.

