

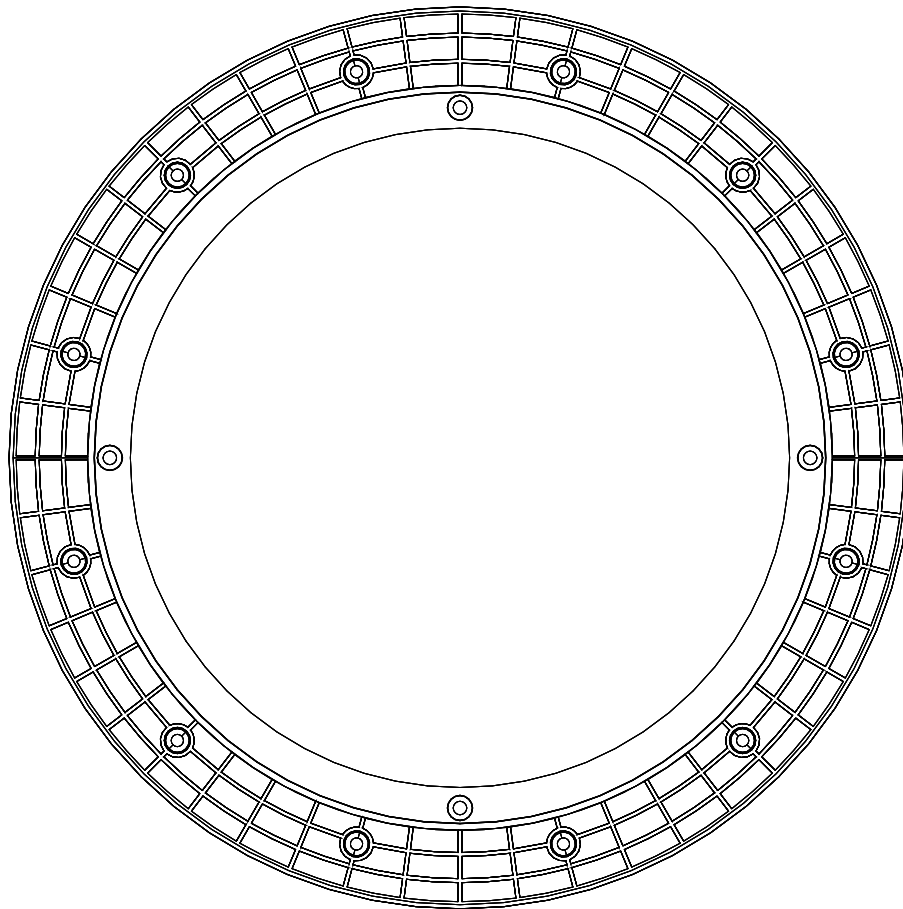

ESS-FLUSH-IC Series
Episode Flush Mount Bracket



Install Guide

Install

1. Select the location for the speaker and mark the center. Cutout dimensions are provided in the table below.

	ESS-FLUSH-IC-4	ESS-FLUSH-IC-6	ESS-FLUSH-IC-8
Cutout Diameter	7.62"	9.76"	11.12"

Pro Tip: Avoid any studs or joists in the ceiling or wall.

2. Use the supplied cutout template to mark the area to be cut.

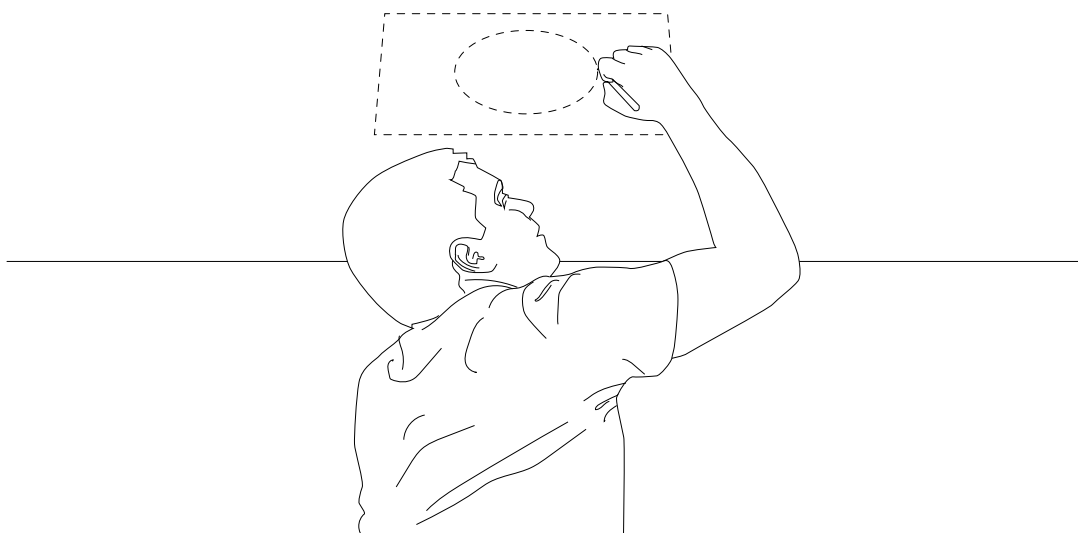

3. Cut around the marked area and remove the piece of drywall.

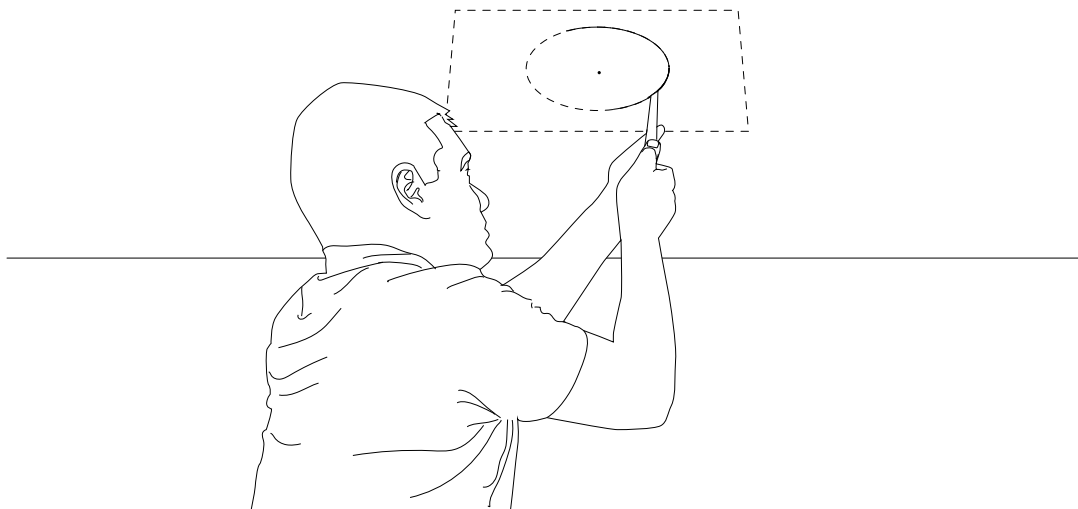

4. Fit the bracket into the opening and ensure it sits flat against the drywall.

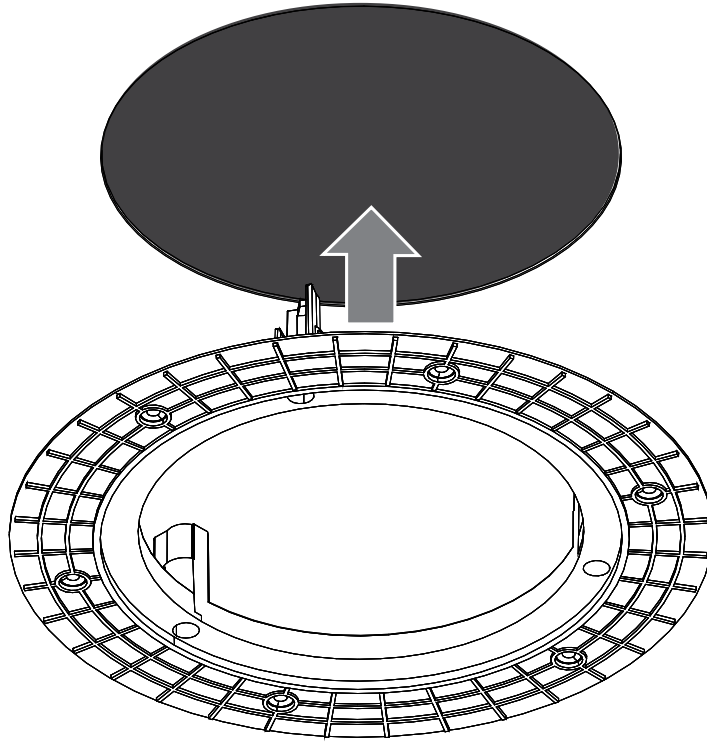

5. Tighten down the dog ears on the bracket to ensure it is tight in the ceiling.

Pro Tip: The bracket supports the weight of the speaker once installed, so secure it firmly.

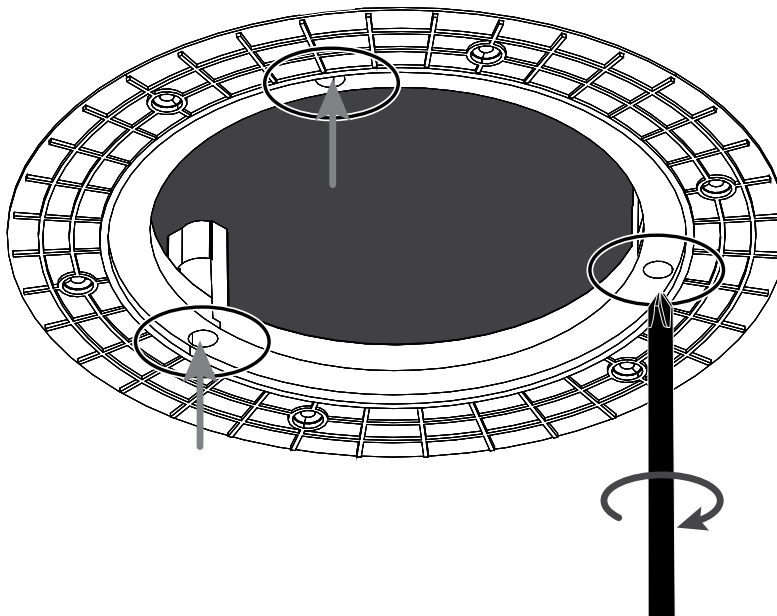

6. This step is **optional**. If there are sections of the flange that fit loosely against the ceiling or wall, use drywall screws (or other flat head hardware) to secure the bracket to the drywall.

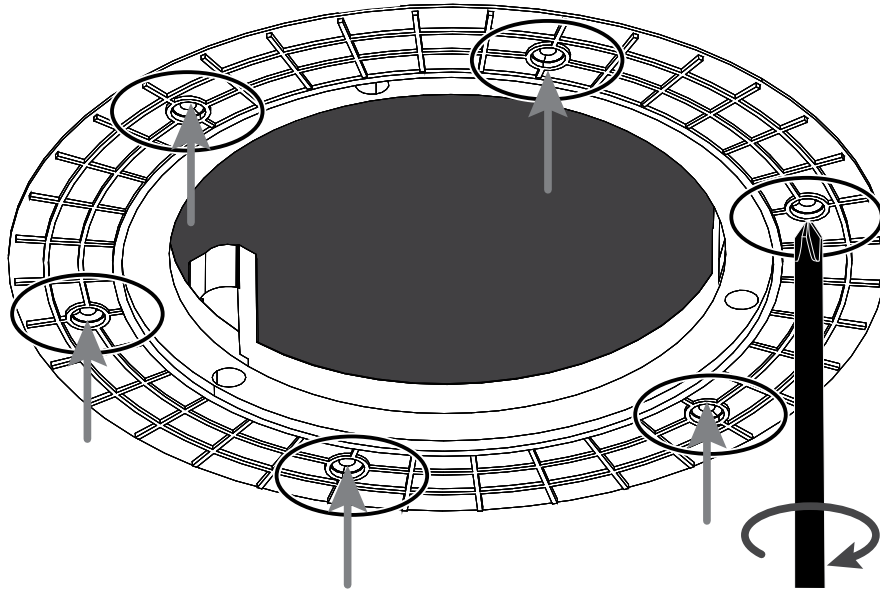

7. Test fit the speaker once the bracket and flange are secured into the ceiling.

Pro Tip: Engaging the dog ears of the speaker is not mandatory.

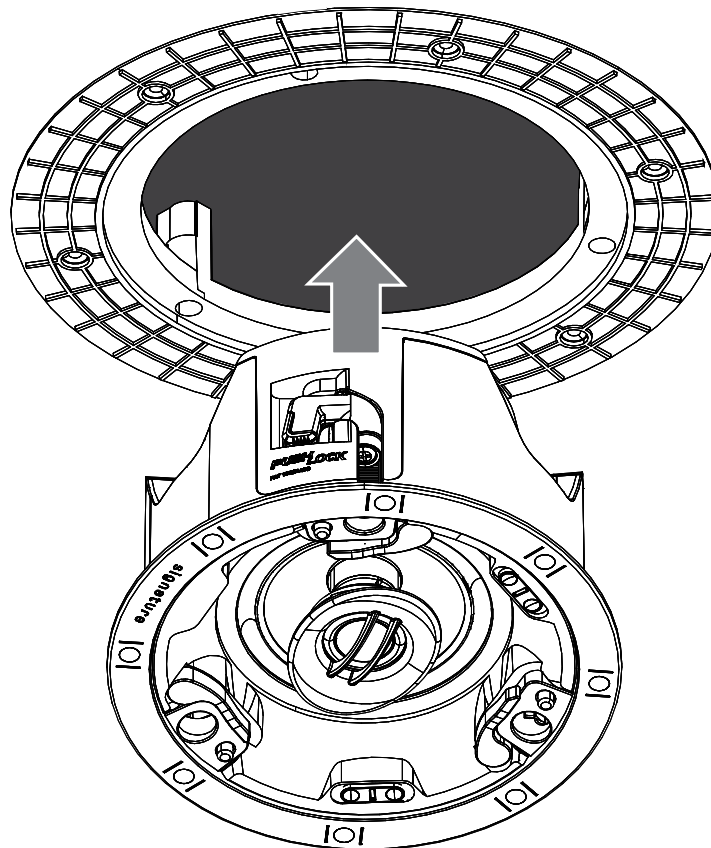

8. Remove the speaker and install the mud guard. Apply drywall mud over the bracket to seal and blend the bracket into the ceiling.

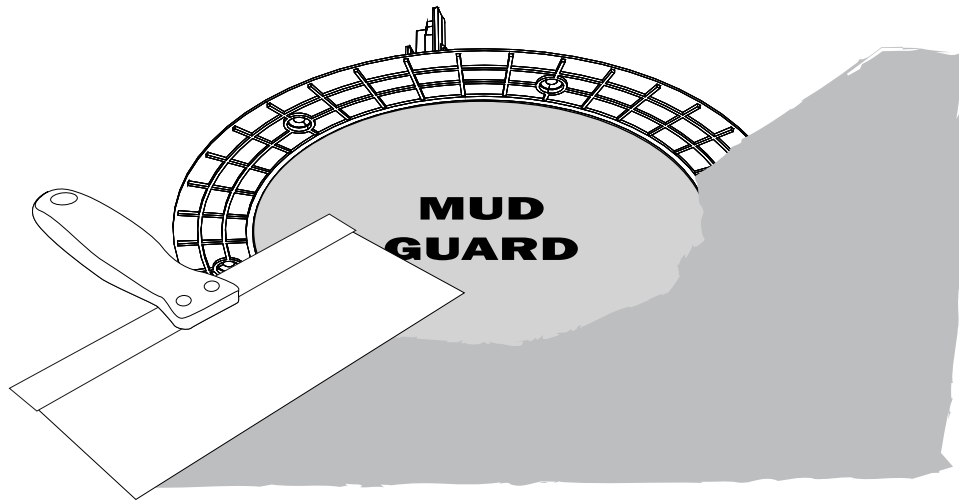

9. Remove the mud guard.

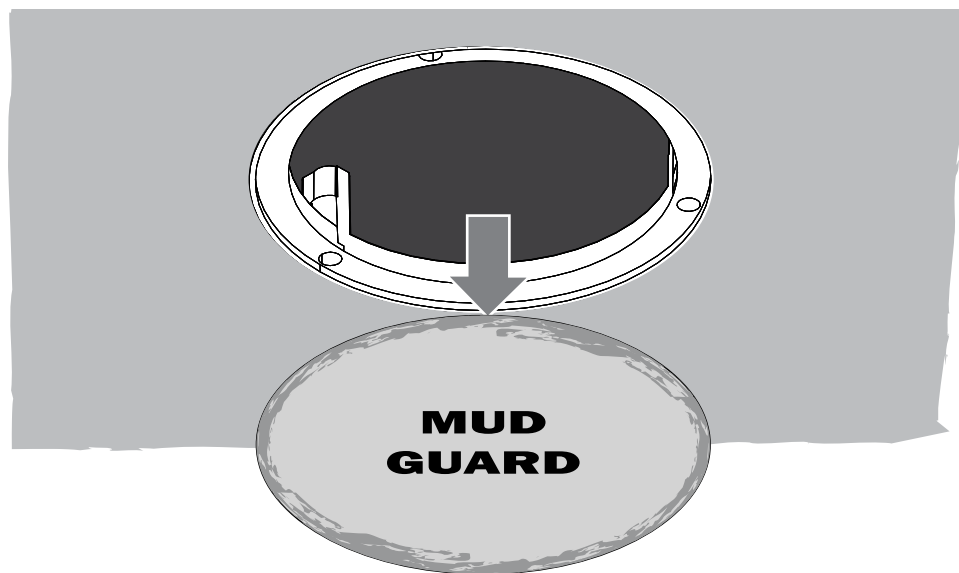

Pro Tip: Ensure there is no mud on the inner lip of the bracket. Mud in this area will affect proper speaker mounting.

10. Paint the drywall, then install the speaker.

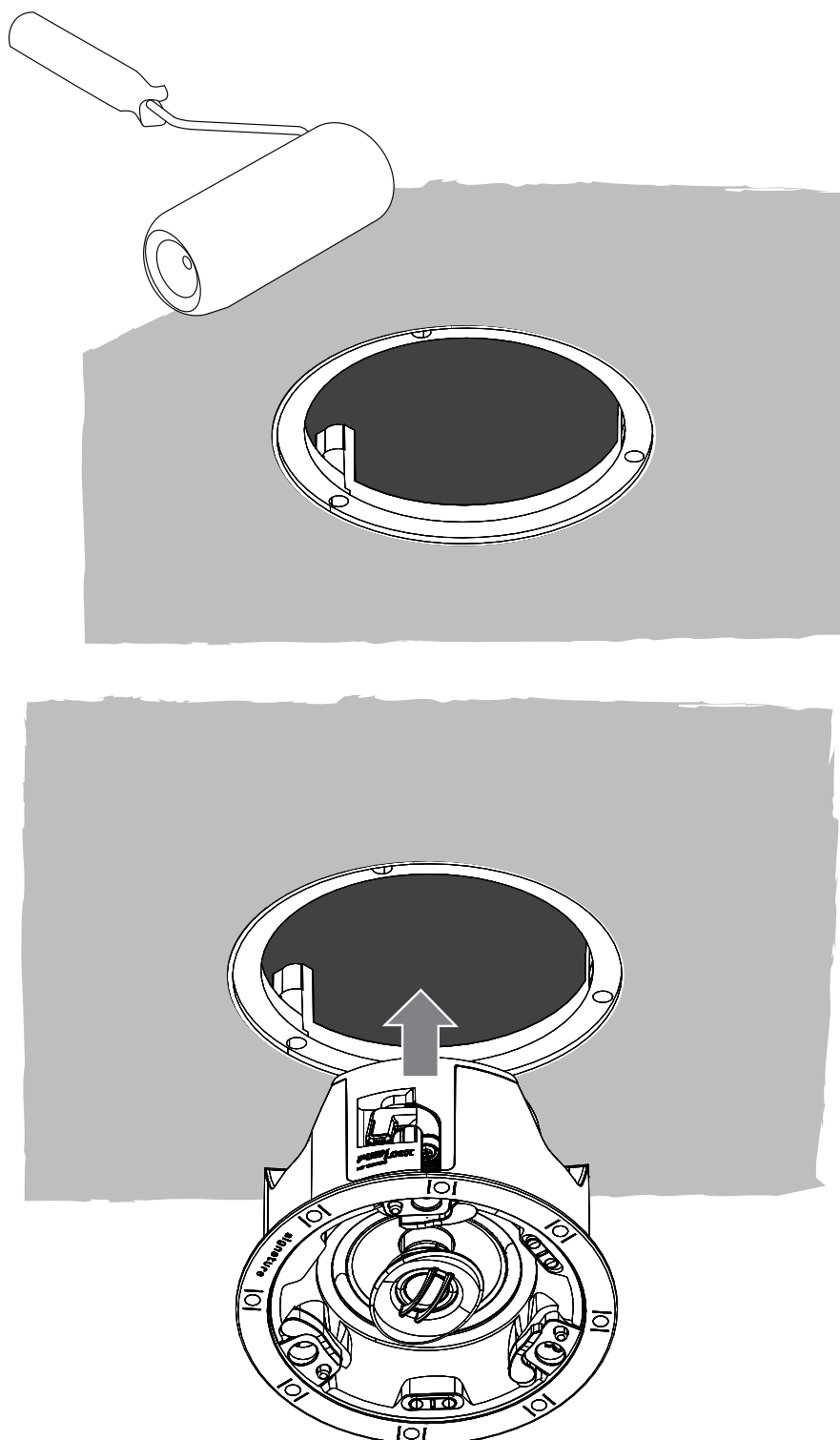

11. Install a round frameless grille (SKU: ESS-GLXRND-IC-X), which attaches magnetically to the speaker.

Warranty and Legal Notices

Find details of the product's Limited Warranty at snapone.com/legal/ or request a paper copy from Customer Service at **866.424.4489**. Find other legal resources, such as regulatory notices and patent and safety information, at snapone.com/legal/.

Copyright ©2022, Snap One, LLC. All rights reserved. Snap One its respective logos are registered trademarks or trademarks of Snap One, LLC, in the United States and/or other countries. Control4 and Episode are also registered trademarks or trademarks of Snap One, LLC. Other names and brands may be claimed as the property of their respective owners. Snap One makes no claim that the information contained herein covers all installation scenarios and contingencies, or product use risks. Information within this specification subject to change without notice. All specifications subject to change without notice.

Version 220222-0800

Part # 200-ESS-FLUSH-IC-A