



B350 Access Point

Scan for Unleashed Set-Up Documentation



snpl.co/unleashed



B350 Access Point

Scan for ARCC Cloud-Based Controller
Set-Up Documentation



snpl.co/ARCC

Technical Support

For All Partners:

Email: support-case@accessnetworks.com

For Snap One Partners:

Visit snpl.co/techsupport

Access Networks Partners:

Visit my.accessnetworks.com/partners/ and open a case.

Warranty and Other Legal Notices

Find the details of the product's Limited Warranty on the support tab for each Access Point model on my.accessnetworks.com or snapav.com.

Package Contents

A complete B350 field-installation package includes all of the following items:

- B350 Access Point
- M25 data cable gland
- Ground wire with lug
- Pole/Wall Mount Bracket Kit
- Two steel pipe clamps
- Declaration of Conformity/Regulatory Statement

FIGURE 1 B350 Package Contents

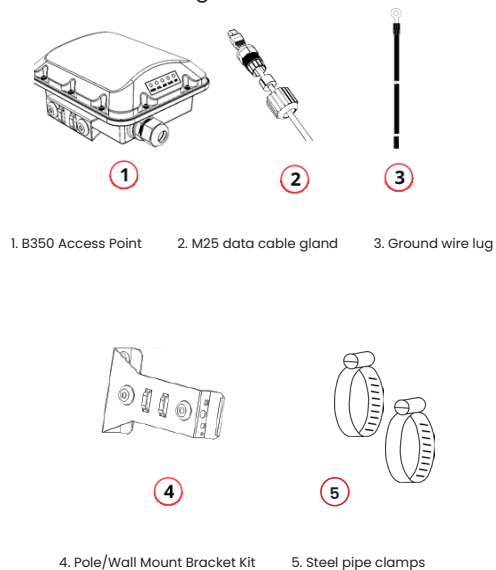

FIGURE 2 B350 Access Point: Top View

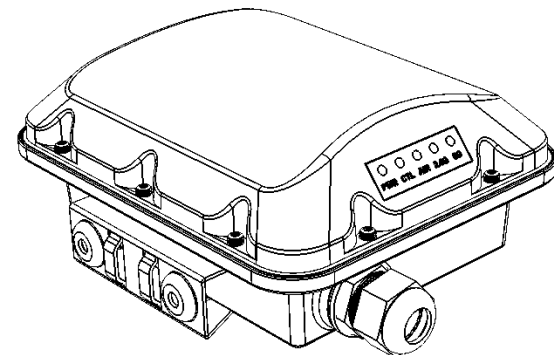

TABLE 1 B350 Power

Power Mode	System Configuration	Max Power Consumption (includes USB power)
802.3at (PoE) - Class 4	• Full Functionality	13.24W
802.3af (PoE) - Class 3	• USB Disabled • IoT Disabled	11.42W
Idle (PoE)		7.68W

Mounting Instructions

Required Hardware Tools

- No. 2 Phillips screwdriver
- Small flat-blade screwdriver
- Wide flat-blade screwdriver
- Torque wrench or torque screwdriver with sockets
- Long-nose pliers
- Electrical wire-stripping and terminal-crimping pliers
- Pipe or pole, or a sturdy flat surface
- Electric drill with drill bits and customer-supplied wall anchors, flat washers, and hex nuts for flat-surface mount

Connecting and Sealing the RJ-45 Cables

WARNING! Do not use any PoE injector not tested and approved by Access Networks to power the B350 Access Point.

1. Feed the end of the cable through the sealing nut, rubber O-ring, clamping ring assembly, and cable gland base, as shown in Figure 3.

NOTE: Do not seat the clamping ring and rubber O-ring into the gland body until the gland body has been torqued to specifications.

FIGURE 3 RJ-45 Cable and Gland Assembly

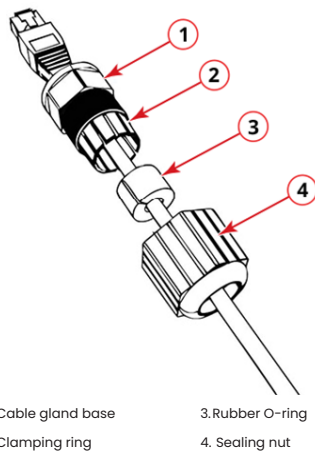

2. Use a wide flat-blade screwdriver to remove the required (PoE IN) blanking cap from the AP.
3. Connect the cable to the Ethernet port on the AP.
4. Tighten the cable gland base into the AP chassis to 7 N.m or 62 in-lbs.
5. Wrap the clamping ring assembly around the rubber O-ring. Make sure that the clamping ring assembly fully encloses the rubber O-ring.
6. Seat the clamping ring assembly and rubber O-ring in the cable gland base.
7. Hand-tighten the sealing nut.

Attaching the Mounting Bracket to a Flat Surface

1. The AP mounting bracket attaches to the AP using a captive screw. Use a medium flat-blade or No. 2 Phillips screwdriver to loosen the captive screw, as shown in Figure 8, and pull up on the end of the bracket to remove the bracket from the AP, as shown in Figure 4.

FIGURE 4 Removing the Mounting Bracket

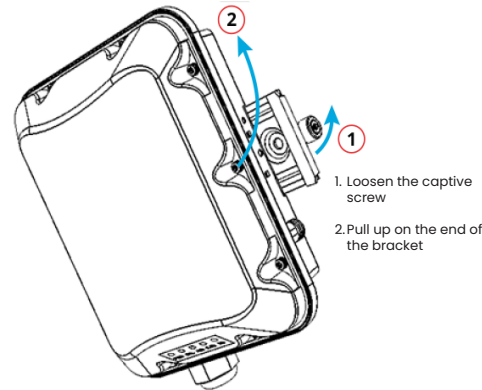

2. Using either of the two options shown in Figure 5, hold the mounting bracket at the location on the mounting surface where you want to mount the AP. Use the holes on the mounting bracket as a template to mark the locations of the mounting holes.

NOTE: The mounting bracket can be mounted to a vertical or horizontal surface to support the AP in the required orientation.

FIGURE 5 Mounting Bracket on a Flat Surface

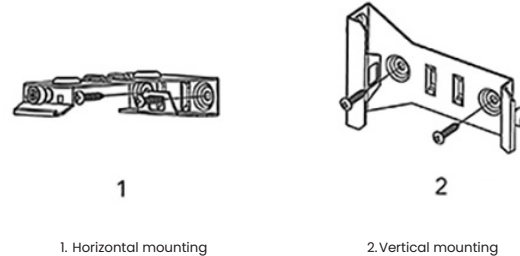

3. Remove the mounting bracket from the mounting surface.
4. Drill holes required for the customer-supplied mounting hardware.
5. Attach the mounting bracket to the flat surface using the mounting hardware.
6. Using the mounting hardware instructions, tighten the hardware to secure the mounting bracket.
7. Continue with Mounting the AP section.

Attaching the Mounting Bracket to a Pole

1. The AP mounting bracket attaches to the AP using a captive screw. Loosen the screw and pull up on the end of the bracket to remove the bracket from the AP, as shown in Figure 4.
2. Insert the open end of one steel clamp into two of the slots on the mounting bracket.

NOTE: The mounting bracket can be mounted to a vertical or horizontal pole to support the AP in the required orientation.

3. Using either of the two options shown, use the clamps to attach the mounting bracket to the pole. Tighten the clamps to 3 N.m or 27 in-lbs, or per manufacturer's specifications if the factory-supplied clamps are not used.
4. If necessary, daisy-chain the other steel clamps to accommodate larger poles.
5. Continue with Mounting the AP section.

FIGURE 6 Mounting Bracket on a Pole

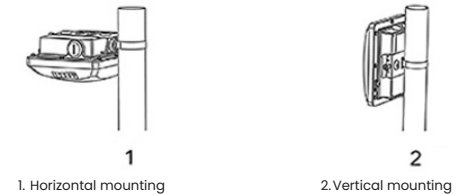

Mounting the AP

- 1. Snap the AP back onto the mounting bracket, as shown in Figure 7, and use a medium flat-blade or No. 2 Phillips screwdriver to tighten the captive screw to 1.1 N.m or 10 in-lbs to secure the bracket to the AP, as shown in Figure 7.

FIGURE 7 Attaching the Mounting Bracket to the AP

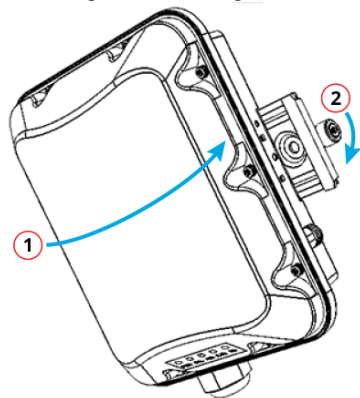

1. Snap the AP to the mounting bracket
2. Tighten the captive screw

- 2. Optional Step: If you also need to lock the mounting bracket to the AP, then use an appropriately sized screwdriver to screw the customer-supplied locking stainless steel 6-mm M3 pinhead security screw through the mounting bracket and into the AP chassis.

CAUTION! Make sure that the customer-supplied locking stainless steel M3 pinhead security screw is no longer than 6 mm. If the security screw is longer than 6 mm, it can damage the AP chassis.

FIGURE 8 Locking the Mounting Bracket to the AP

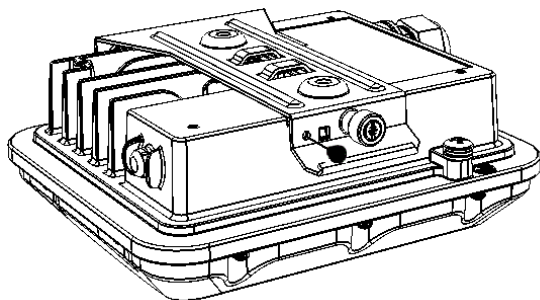

Earth Grounding the AP

CAUTION! Make sure that earth grounding is available and that it meets local and national electrical codes. For additional lightning protection, use lightning rods and lightning arrestors.

NOTE: The color coding of ground wires varies by region. Before completing this step, check your local wiring standards for guidance.

Using the factory-supplied ground wire and ground screw and washer set, connect a good earth ground to the AP chassis ground point.

CAUTION! The B350 AP includes one 9mm stainless steel M6x1 earth ground screw with split lock and flat washers. Make sure that any replacement screw is no longer than 9 mm. If a screw is longer than 9mm, it can damage the AP chassis.

FIGURE 9 Connecting a Good Earth Ground to the AP

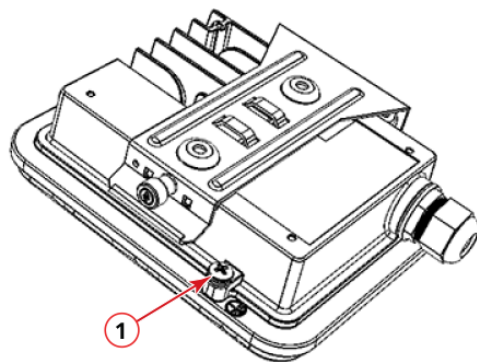

1. Earth ground screw

Troubleshooting

CAUTION! If required, you can reset the AP to its factory default settings by pressing the reset button located inside the PoE IN port. Use the tip of a pen or a 3-mm flat-blade screwdriver to press the reset button. Press and hold the reset button for 4 seconds or longer to restore to factory defaults. **DO NOT RESET THE AP TO FACTORY DEFAULT SETTINGS UNLESS SO INSTRUCTED.** (Doing this resets the IP address of the AP to 192.168.0.1)

NOTE: After a reset, you can access the internal AP web interface using <https://192.168.0.1>. Your device must use any other address from 192.168.0.2 through 192.168.0.254, with subnet mask 255.255.255.0. The username is super, and the password is sp-admin.

For More Information

For information on how to configure and manage the AP, refer to the Access Networks Partner Portal Resource Center, available at <https://my.accessnetworks.com/kb/>

Copyright ©2022, Snap One, LLC. All rights reserved.

Access Networks is a trademark of Snap One, LLC. and/or its affiliates.

Wi-Fi Alliance, Wi-Fi, the Wi-Fi logo, Wi-Fi Certified, the Wi-Fi CERTIFIED logo, Wi-Fi Protected Access, the Wi-Fi Protected Setup logo, Wi-Fi Protected Setup, Wi-Fi Multimedia and WPA2 and WMM are trademarks or registered trademarks of Wi-Fi Alliance. All other trademarks are the property of their respective owners.

TABLE 2 B350 Optional Accessories

SKU	Description
902-0162-US00	• Gigabit PoE Injector (24W) (10/100/1000 Mbps)
902-0125-0000	• Secure articulating mounting bracket
902-0127-0000	• Extended cap to accommodate up to 6 cm long USB dongle
902-1121-0000	• Spare weatherizing cable gland with option of one hole or 2 hole connection
902-0183-0000	• Spare cable gland for weatherizing the RJ-45 ports on outdoor APs